



## 2022 PRODUCT PRICE LIST

**REVISION #1- Price Increase Effective  
January 1, 2022**



# TABLE OF CONTENTS

---

AXENT.ONE C PLUS 2.0 (E314-02)	PG 1
AXENT ONE PLUS WALL HUNG INTELLIGENT TOILET (E310-E291-U1)	PG 2
AXENT.ONE C ABOVE COUNTER BASIN (L316-1101-U1)	PG 3
AXENT.ONE C COUNTER TOP BASIN (L310-1101-U1)	PG 4
AXENT.ONE C UNDER COUNTER BASIN (L017-4101-U1)	PG 5
PRIMUS 2.0 TANKLESS TOILET (W331-04)	PG 6
HI-FLUSH KIT (A027-0101)	PG 7
ITALICA ONE-PIECE TOILET (W379-2020)	PG 8
DUNE II ONE-PIECE TOILET (W589-1131-U1)	PG 9
DUNE II COUNTER TOP BASIN (L587-7101-U1 & L588-7201-U1)	PG 10-11
PENINSULA ONE-PIECE TOILET (W531-1131-U1)	PG 12
PENINSULA TWO-PIECE TOILET (W532-2020)	PG 13
PENINSULA ABOVE COUNTER BASIN (L530-3101-U1)	PG 14
ANNIE COUNTER TOP BASIN (L370-1101-U1)	PG 15
MILTON INTELLIGENT BIDET TOILET SEAT (E001-0201-U1)	PG 16
NON-ELECTRIC BIDET SEATS (FB106, FB107, & FB108)	PG 17-19
LITE E-BIDET SEATS (FE105 & FE106)	PG 20-21
TERMS & CONDITIONS	PG 22
WARRANTY	PG 23

# AXENT.ONE C PLUS

**AXENT.ONE C PLUS 2.0 INTELLIGENT TOILET  
(WITH ECO-POWERFLUSH) E314-02**

**LIST PRICE: \$6,100.00 USD**

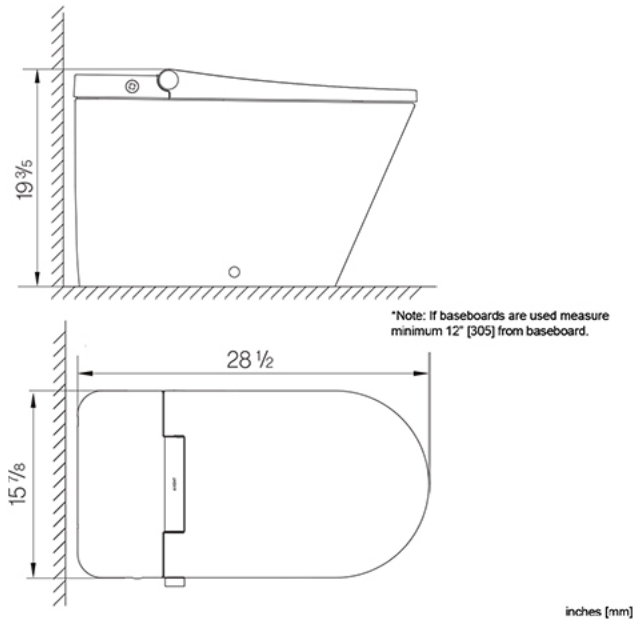

## FEATURES

Dimensions	L 28 1/2" x W 15 7/8" x H 19 1/4"	
Weight	110 lbs.	
Material Finish	Vitreous China and Easy Clean Antibacterial Glaze	
Color	White and Chrome Trim	
Water Consumption	Single Flush 1.1 GPF (4.1 LPF)	
Configuration	12" Rough-In Floor Mounted / Siphonic Elongated Bowl Shape ADA Height Toilet Bowl Manual and Remote Activated Flushing Patented Tankless Technology Patented Eco PowerFlush System (PAT) Smart Phone App Enabled Control	Customizable Integrated Bidet Seat Warm Air Dryer Deodorizer Adjustable Self-Warming Seat Instantly Warm Water Temperature Adjustable Shower Flow and Massaging Automated Hands-Free, Soft-Closing Seat and Lid Easy Clean Antibacterial Coating

## CODES/STANDARDS

IAPMO EGS Listed  
 ASME A112.4.2, ASME A112.18.1/CSA B125.1, UL 1431, CSA C22.2 64 and 678  
 ASME 112.19.2-2013/CSA B45.1-13, ASSE1002  
 Eco PowerFlush System (PAT) 1.1. GPF  
 MAP RATING HIGHLY RECOMMENDED Flush Performance  
 EPA WaterSense®

## DETAILS

The AXENT.ONE C+ 2.0 intelligent toilet redefines intuitive design and adaptable technology. This award-winning intelligent toilet is equipped with the latest smartware technology customize your AXENT.ONE C+ 2.0 functions with the swipe of a sensor or click of a button.

The AXENT.ONE C+ 2.0 is paired with the Eco PowerFlush flushing system. This tankless design and powerful flushing efficiency lends to the Axent.One C+ 2.0 one-of-a-kind water conservation benefits and eliminates the need for unnecessary ceramic (a reduction of more than 25% less materials than traditional toilets)

## AXENT Switzerland

support@axentproducts.com

www.axentbath.us

1.800.769.4857

All drawings contain the necessary measurements which are subject to standard tolerances. They are stated in mm and are non-binding. Exact measurements, in particular for customised installation scenarios, can only be taken from the finished ceramic piece.



# AXENT.ONE PLUS

WALL-HUNG INTELLIGENT TOILET E310-E291-U1

LIST PRICE: \$5,300.00 USD

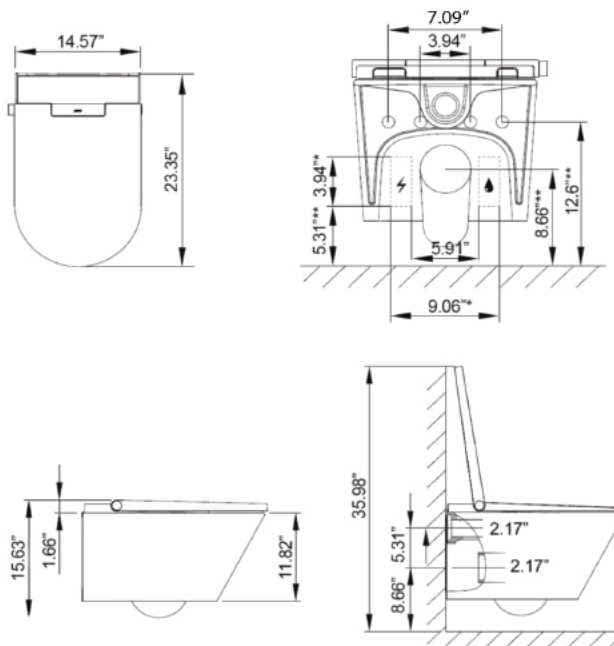

\*Approximate  
\*\*Will Vary



DESIGN  
AWARD  
2018



reddot design award

## FEATURES

Dimensions	L 23.35" x W 14.57" x H 15.63"	
Weight	88.2 lbs	
Power Consumption	1100W (120V, 60Hz)	
Material Finish	Vitreous China and Polypropylene	
Color	White	
Water Consumption	Dual Flush Capability	Warm Air Dryer
Configuration	Elongated Bowl Shape	Deodorizer
	ADA Height Toilet Bowl	Adjustable Self-Warming Seat
	Manual Activated Flushing	Instantly-Warm Water Temperature
	Intuitive Night Light	Adjustable shower flow and massaging
	Customizable Integrated Bidet Seat	Easy Clean Antibacterial Coating
		Rimless Flush Design

## CODES/STANDARDS

ASME A112.4.2, ASME A112.18.1, CSA B125.1, UL 1431, CSA C22.2 64 and 678  
Ultra High Efficiency Toilet (UHET) at 1.1 GPF  
Highly Recommended Flush Performance

## DETAILS

The AXENT.ONE Plus wall-hung intelligent toilet is AXENT's latest smart bathroom innovation. Designed by Matteo Thun, this luxurious low-profile, tankless intelligent toilet offers all the bells and whistles of modern integrated bidet toilets with the added allure of purposeful design. Boasting an astounding 8 inches of space-saving appeal, the AXENT.ONE Plus floats above your bathroom floor at a comfortable, ADA compliant height offering an easy-to-clean and convenient bathroom solution.

## AXENT Switzerland

support@axentproducts.com  
www.axentbath.us  
1.800.769.4857

All drawings contain the necessary measurements which are subject to standard tolerances. They are stated in inches and are non-binding. Exact measurements, in particular for customised installation scenarios, can only be taken from the finished ceramic piece.

# AXENT.ONE C

ABOVE COUNTER BASIN L316-1101-U1

LIST PRICE: \$499.00 USD

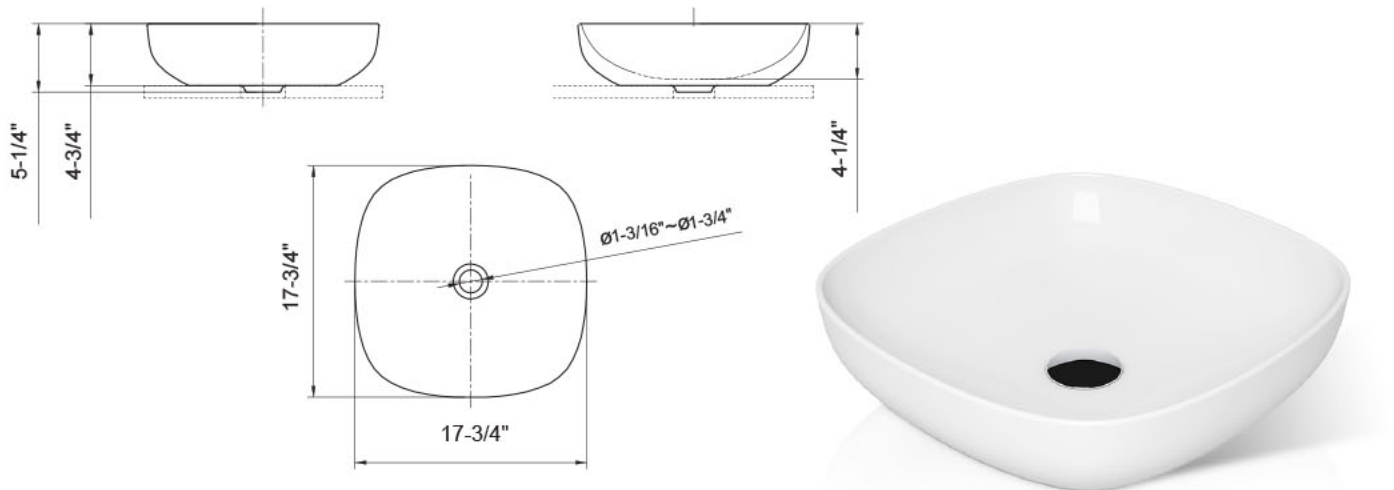

\*Drain hole fits standard US drain fixtures  
(diameter: 1.63" - 1.75")

\*Drain not included

## FEATURES

Dimensions	L 17-3/4" x W 17-3/4" x H 5-1/4"
Gross/Net Weight	25.4 lbs
Material Finish	Fine Fire Clay (FFC)
Color	White

## CODES/STANDARDS

ASME A112.19.2-2013/CSA B45.1-13

ADA compliant when installed to ADA specification requirements.

## DETAILS

This basin features beautiful structure, gracious shapes and elegant, thin edges. A masterpiece of craftsmanship, the AXENT.ONE C Counter Top washbasin features no tap hole, no overflow hole and an Easy Clean glaze for easy lifetime maintenance.

## AXENT Switzerland

support@axentproducts.com

www.axentbath.us

1.800.769.4857

All drawings contain the necessary measurements which are subject to standard tolerances. They are stated in inches and are non-binding. Exact measurements, in particular for customised installation scenarios, can only be taken from the finished ceramic piece.

# AXENT.ONE C

ABOVE COUNTER BASIN L310-1101-U1

LIST PRICE: \$499.00 USD

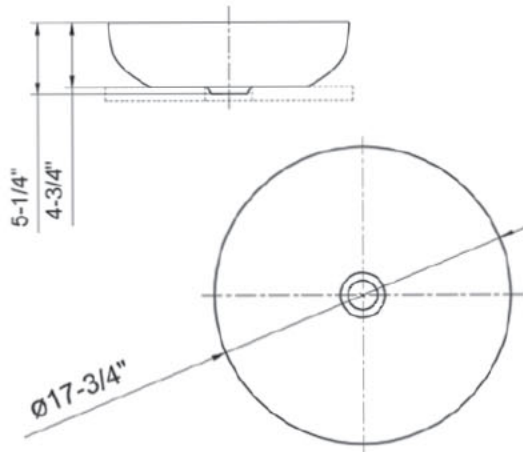

\*Drain not included

\*Drain hole fits standard US drain fixtures  
(diameter: 1.63" - 1.75")

## FEATURES

Dimensions	Dia. 17-3/4" x H 5-1/4"
Gross/Net Weight	22.5 lbs
Material Finish	Fine Fire Clay (FFC)
Color	White

## CODES/STANDARDS

ASME A112.19.2-2013/CSA B45.1-13  
ADA compliant when installed to ADA specification requirements.

## DETAILS

This basin features astonishing beauty, gracious shapes and elegant, thin edges. A masterpiece of craftsmanship, the AXENT.ONE C Counter Top washbasin features no tap hole, no overflow hole and Easy Clean glaze for easy maintenance.

# AXENT.ONE C

UNDER COUNTER BASIN L017-4101-U1

LIST PRICE: \$199.00 USD

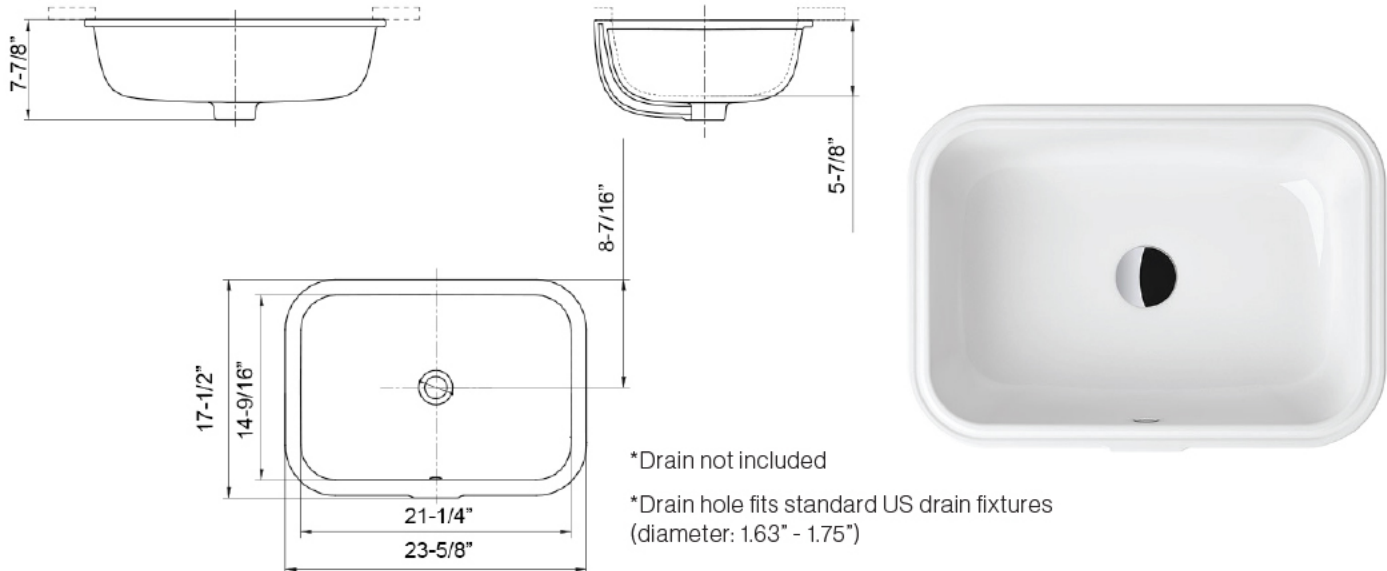

## FEATURES

Dimensions	L 23 5/8" x W 17 1/2" x D 7-7/8"
Gross/Net Weight	29.1 lbs / 27 lbs
Material Finish	Vitreous China (VC)
Color	White

## CODES/STANDARDS

ASME A112.19.2-2013/CSA B45.1-13  
ADA compliant when installed to ADA specification requirements.

## DETAILS

This rectangular under counter basin features one overflow hole, an overflow cover, and Easy Clean glaze for easy lifetime maintenance.

# PRIMUS 2.0

TANKLESS TOILET (WITH ECO-POWERFLUSH) W331-04

LIST PRICE: \$1,500.00 USD

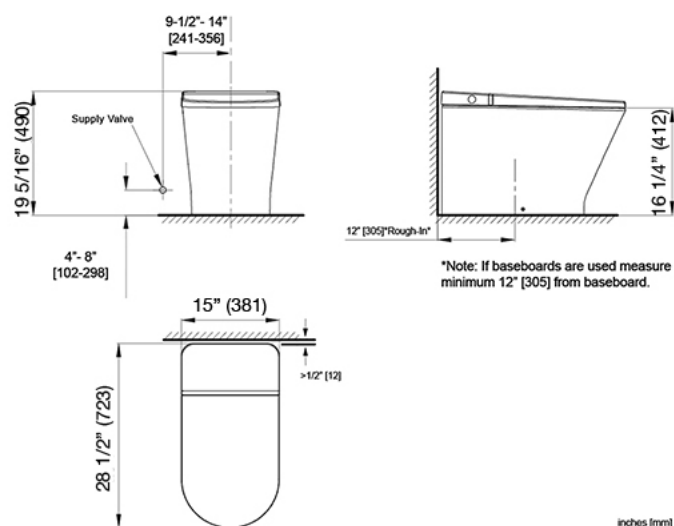

## FEATURES

Dimensions	L 28 1/2" x W 15" x H 19 5/16"	
Weight	110 lbs	
Material Finish	Vitreous China and Easy Clean Antibacterial Glaze	
Color	White with Space Silver Trim (ALT: Champagne Gold, Rose Gold, White, & Matte Black Trims SOLD SEPERATLY) Primus Color Trims Options:	
Water Consumption	Single Flush 1.1 GPF (4.1 LPF)	Champagne Gold (W330-D002-U1): \$80 USD
Optional	Hi- Flush Touchless Flush Kit (A027-0101) (SOLD SEPERATELY)	Rose Gold (W330-D003-U1): \$80 USD White (W330-D004-U1): \$80 USD Matte Black (W330-D005-U1): \$80 USD

## CODES/STANDARDS

ASME A112.19.2-2013/CSA B45.1-13, ASSE 1002  
Eco PowerFlush Flushing System (PAT) 1.1 GPF  
MAP RATING HIGHLY RECOMMENDED Flush Performance  
EPA WaterSense®

## DETAILS

The Primus 2.0 tankless toilet is the core of AXENT's complex and skillful engineered technologies showcased in an exceptionally simple yet modern low-profile design. Its tankless design takes up less space than traditional toilets and incorporates engineering innovations to offer less design intrusion with more flushing excellence.

The Primus 2.0 is paired with the Eco PowerFlush flushing system. This tankless design and powerful flushing efficiency lends to the Primus' 2.0 one-of-a-kind water conservation benefits and eliminates the need for unnecessary ceramic (a reduction of more than 25% less materials than traditional toilets

## AXENT Switzerland

support@axentproducts.com  
www.axentbath.us  
1.800.769.4857

All drawings contain the necessary measurments which are subject to standard tolerances. They are stated in inches and are non-binding. Exact measurments, in particular for customised installtion scenarios, can only be taken from the finished ceramic piece.

# HI-FLUSH KIT

**WIRELESS FLUSH SENSOR** A027-0101

**LIST PRICE: \$399.00 USD**

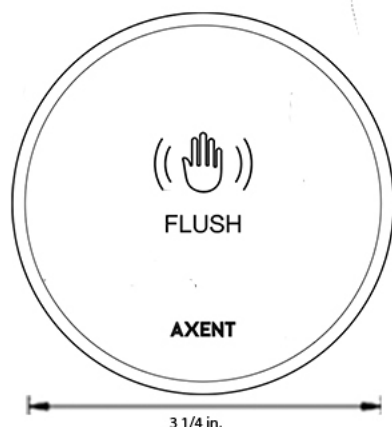

## FEATURES

Dimensions	3 1/4" Diameter
Weight	1 1/2 Lbs
Color	White
Configuration	Compatible with Primus 2.0 (W331-04) ONLY

## DETAILS

The AXENT HI-FLUSH KIT is the safe germ-free way to flushing a toilet. Through the use of touchless technology the vessel has the ability to respond and instantly flush with just the swipe of a hand. With the use of AAA batteries for the sensor and AA batteries for the receiver inside the vessel. The AXENT HI-FUSH KIT gives you a powerful flush in the palm of your hands.

# ITALICA

**ONE- PIECE SKIRTED TOILET** W379-2020

**LIST PRICE: \$799.00 USD**

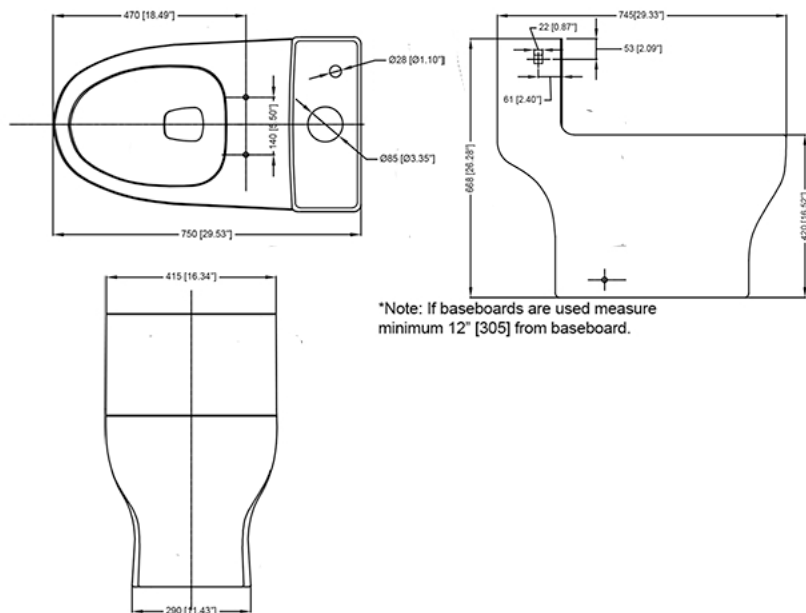

## FEATURES

Dimensions	L 29.33" x W16.34" x H 26.28"
Weight	103 lbs (46 kg)
Material Finish	Vitreous China
Color	White
Water Consumption	Single Flush 1.28 GPF (4.8L GPF)
Configuration	12" Rough In Floor mounted/ Siphonic Elongated Bowl Shape ADA Height Toilet Bowl One Piece Skirted Rimless flush design

Seat (Included): G379-0111-U1 - \$80 USD  
Optional Tank Lever  
 MB6023.PC: Polished Chrome - \$65 USD  
 MB6023.WH: White - \$65 USD

## CODES/STANDARDS

ASME A112.19.2-2013/CSA B45.1-13, ASSE 1002  
 Single flush PREMIUM High-Efficiency toilet (HET) at 1.28 GPF (4.8 LPF)  
 MAP RATING HIGHLY RECOMMENDED FLUSH PERFORMANCE  
 EPA WaterSense®

## DETAILS

Rich with soft angles and full curves, the Italica Toilet epitomizes a balanced union between modern and classic design. The Italica One-Piece Skirted Toilet includes a rimless flush design, a bottom inlet with a vertical outlet, a 1.28 GPF (4.8L) flush, 12" rough-in and is protected with an Easy Clean glaze for easy lifetime maintenance.

## AXENT

support@axentproducts.com  
 www.axentbath.us  
 1.800.769.4857

All drawings contain the necessary measurements which are subject to standard tolerances. They are stated in inches and are non-binding. Exact measurements, in particular for customized installation scenarios, can only be taken from the finished ceramic piece.

# DUNE II

**DUNE II One-Piece Dual Flush Toilet** W589-1131-U1

**LIST PRICE : US\$ 899.00 USD**

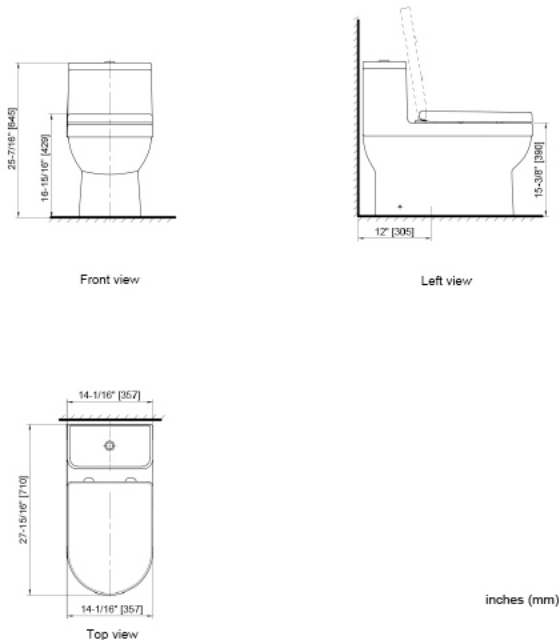

## FEATURES

Dimensions / Weight	L 27-15/16" x W 14-1/16" x H 25-7/16"	
Weight	103.6 lbs	
Material Finish	Vitreous China and Easy Clean Antibacterial Glaze	
Color	White	
Water Consumption	Dual Flush 1.0 GPF/1.6 GPF (3.8LPF/6.1LPF)	Tank Lever: B5590.PC - \$65 USD
Configuration	Rough-In 12"	(Included, Top-Mounted Push Button/ Polished Chrome)
	Floor Mounted/Siphonic	Seat (Included): G110-0111-U1 - \$100 USD
	Elongated Bowl Shape	
	One Piece Toilet	

## CODES/STANDARDS

ASME A112.19.2-2013/CSA B45.1-13, ASSE 1002

## DETAILS

A dynamic combination of subtle curves and sharp geometric lines give the Dune collection its beautifully quirky character. The Dune II one-piece dual flush toilet offers environmental efficiency in a modern design.



# DUNE II

COUNTER TOP BASIN (SINGLE HOLE) L587-7101-U1

LIST PRICE : US\$ 469.00

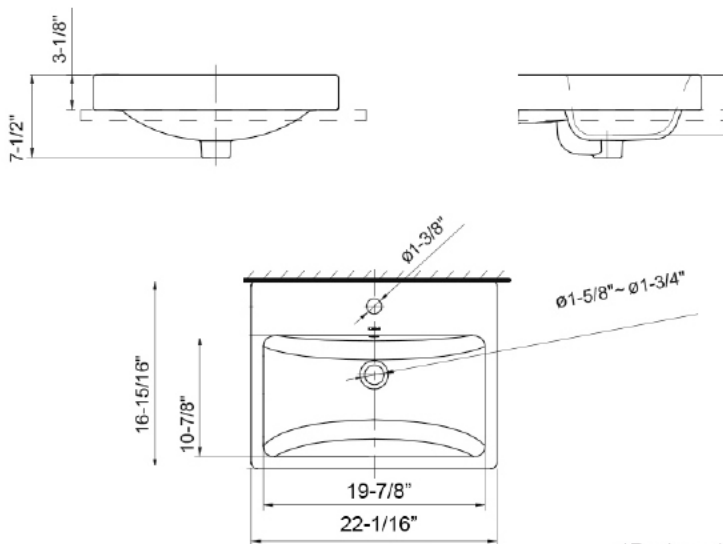

\*Drain not included

\*Drain hole fits standard US drain fixtures  
(diameter: 1.63" - 1.75")

## FEATURES

Dimensions	L 22-1/16" x W 16-15/16" x H 7-1/2"
Gross/Net Weight	32 lbs / 28 lbs
Material Finish	Fine Fire Clay (FFC)
Color	White

## CODES/STANDARDS

ASME A112.19.2-2013/CSA B45.1-13

ADA compliant when installed to ADA specification requirements.

## DETAILS

A dynamic combination of subtle curves and sharp geometric lines give the Dune II Counter Top Basin a unique, beautifully designed profile. This basin scores with clean angular shapes, one overflow hole, one tap hole and Easy Clean glaze for easy long-term maintenance.

## DUNE II

COUNTER TOP BASIN (WIDE SPREAD) L588-7201-U1

LIST PRICE : US\$ 469.00

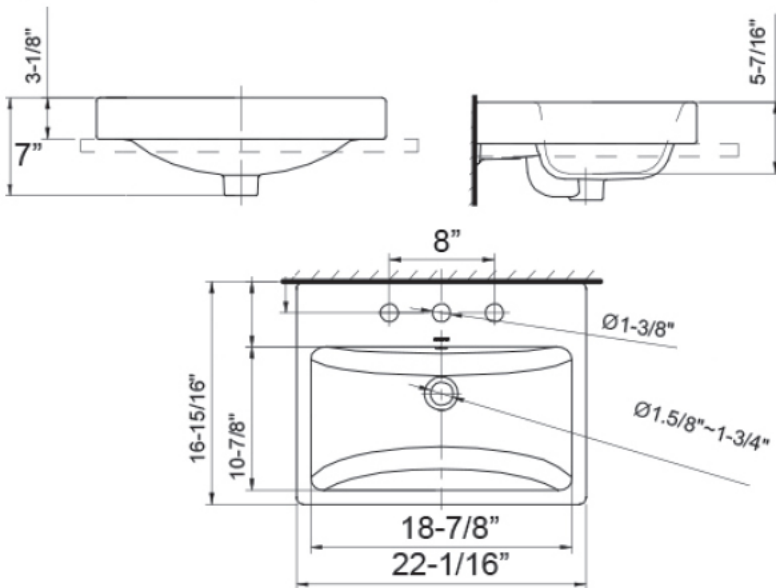

\*Drain not included

\*Drain hole fits standard US drain fixtures  
(diameter: 1.63" - 1.75")

### FEATURES

Dimensions	L 22-1/16" x W 16-15/16" x H 7-1/2"
Gross/Net Weight	32 lbs / 30.5 lbs
Material Finish	Fine Fire Clay (FFC)
Color	White

### CODES/STANDARDS

ASME A112.19.2-2013/CSA B45.1-13

ADA compliant when installed to ADA specification requirements.

### DETAILS

A dynamic combination of subtle curves and sharp geometric lines give the Dune II Counter Top Basin a unique, beautifully designed profile. This basin scores with clean angular shapes, one overflow hole, one tap hole and Easy Clean glaze for easy long-term maintenance.

# PENINSULA

Peninsula One-Piece Toilet W531-1131-U1

LIST PRICE : US\$ 699.00

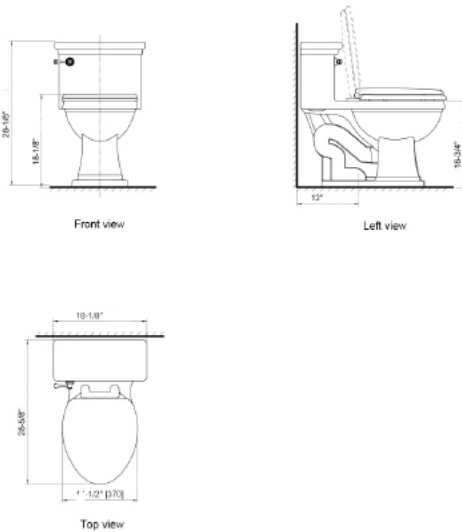

## FEATURES

Dimensions / Weight	L 28-1/8" x W 18-1/8" x H 28-5/32"	
Weight	82.9 lbs	
Material Finish	Vitreous China, Polypropylene and Easy Clean Antibacterial Glaze	
Color	White	
Water Consumption	1.28 GPF (4.8LPF)	
Configuration	Rough-In 12" Floor Mounted/Siphonic Elongated Bowl Shape ADA Height Toilet Bowl One Piece Toilet	
	Tank Lever: B5081.PC - \$65 USD (Included, Left-Sided Handle Lever/ Polished Chrome Brass)	Seat (Included): G202-0211-U1 - \$75 USD
	Optional Tank Levers Satin Nickel (B5081.SN) - \$65 USD Polish Nickel (B5081.PN) - \$65 USD Polish Brass (B5081.PB) - \$65 USD Tuscany Bronze (B5081.TB) - \$65 USD	

## CODES/STANDARDS

ASME A112.19.2-2013/CSA B45.1-13, ASSE 1002  
 Single-Flush PREMIUM High-Efficiency Toilet (UHET) at 1.28 GPF (4.8LPF)  
 MAP Listed-Highly Recommended Flush Performance

## DETAILS

The Peninsula collection features elegant curves while conveying a charming traditional frankness. Our Peninsula One-Piece toilet is equipped with a bottom inlet, vertical outlet, 1.28GPF (4.8L) flush, Easy Clean antibacterial glaze, a silent seat and a 12" rough-in dimension.

# PENINSULA

Peninsula Two-Piece Toilet W532-2020

**LIST PRICE : US\$ 525.00**

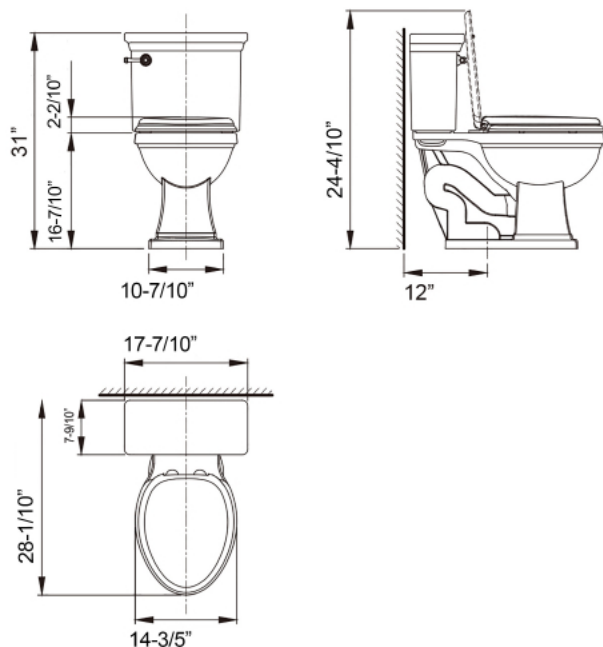

## FEATURES

Dimensions / Weight

L 28-3/16" x W 17-3/4" x H 31"

Weight

82.9 lbs

Material Finish

Vitreous China, Polypropylene and Easy Clean Antibacterial Glaze

Color

White

Water Consumption

1.28 GPF (4.8LPF)

Configuration

Rough-In 12"

Floor Mounted/Siphonic

Elongated Bowl Shape

ADA Height Toilet Bowl

Two Piece Toilet

Optional Tank Levers

Satin Nickel (B5081.SN) - \$65 USD

Polish Nickel (B5081.PN) - \$65 USD

Polish Brass (B5081.PB) - \$65 USD

Tuscany Bronze (B5081.TB) - \$65 USD

Tank Lever: B5081.PC - \$65 USD  
(Included, Left-Sided Handle Lever/  
Polished Chrome Brass)  
Seat: G202-0211-U1 - \$75 USD

## CODES/STANDARDS

ASME A112.19.2-2013/CSA B45.1-13, ASSE 1002

Single-Flush PREMIUM High-Efficiency Toilet (UHET) at 1.28 GPF (4.8LPF)

MAP Listed-Highly Recommended Flush Performance

## DETAILS

The Peninsula collection features elegant curves while conveying a charming traditional frankness. Our Peninsula close coupled toilet is equipped with a bottom inlet, vertical outlet, 1.28GPF (4.8L) flush, Easy Clean antibacterial glaze, a silent seat and a 12" rough-in dimension.

**AXENT Switzerland**

support@axentproducts.com

www.axentbath.us

1.800.769.4857

All drawings contain the necessary measurements which are subject to standard tolerances. They are stated in inches and are non-binding. Exact measurements, in particular for customised installation scenarios, can only be taken from the finished ceramic piece.

# PENINSULA

DROP IN BASIN L530-3101-U1

LIST PRICE: \$ 149.00 USD

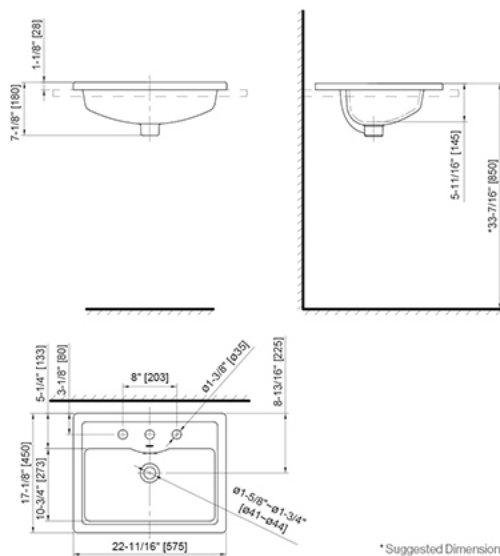

## FEATURES

Dimensions	L 22 11/16" x W 17 1/8" x H 7 1/8"
Gross/Net Weight	26 LBS
Material Finish	Vitreous China
Color	White

## CODES/STANDARDS

ASME A112.19.2-2013/CSA B45.1-13  
ADA compliant when installed to ADA specification requirements.

## DETAILS

Our Peninsula Drop in Basin comes with overflow hole, three tap holes and Easy Clean glaze for extra convenient maintenance.

# ANNIE

COUNTER TOP BASIN L370-1101-U1

LIST PRICE: \$ 199.00 USD

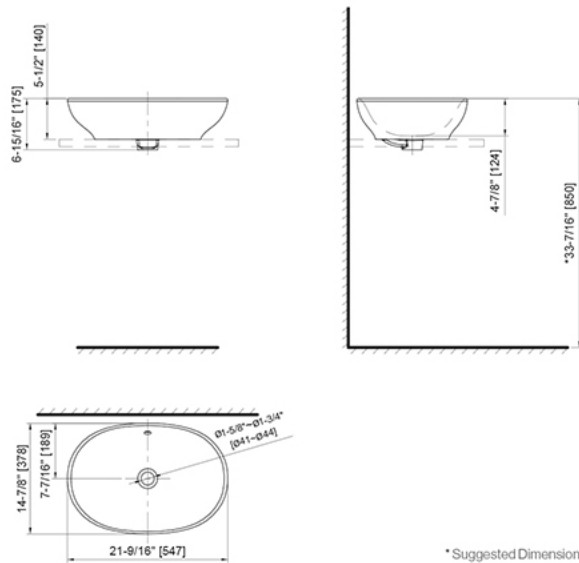

## FEATURES

Dimensions	L 21 9/16" x W 14 7/8" x H 6 15/16"
Gross/Net Weight	22 LBS
Material Finish	Vitreous China
Color	White

## CODES/STANDARDS

ASME A112.19.2-2013/CSA B45.1-13  
ADA compliant when installed to ADA specification requirements.

## DETAILS

The Annie Counter Top Basin comes with overflow hole, without tap hole and with Easy Clean glaze that makes cleaning a breeze.

# MILTON

INTELLIGENT TOILET SEAT E001-0201-U1

LIST PRICE: \$ 1,399.00 USD

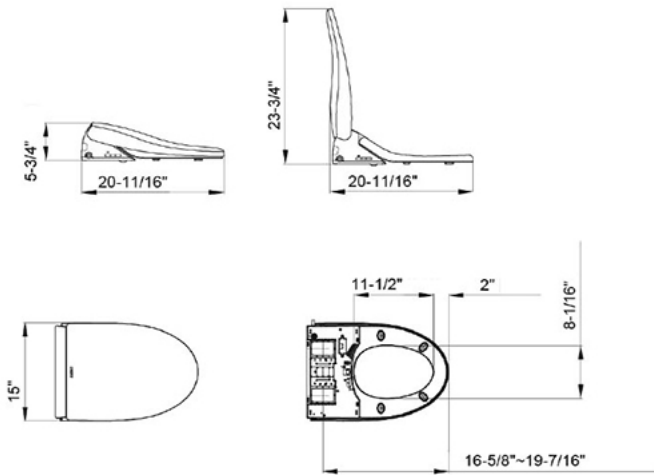

## FEATURES

Dimensions	L 19-7/16" x W 15" x H 5-3/4"	
Weight	17.7 lbs	
Material Finish	Polypropylene	
Color	White	
Configuration	Elongated Bowl Shape Customizable Integrated Bidet Seat Warm Air Dryer Deodorizer Intuitive Night Light	Adjustable Self-Warming Seat Instantly Warm Water Temperature Adjustable shower flow and massaging modes Remote Control

## CODES/STANDARDS

ASME A112.4.2, ASME A112.18.1, CSA B125.1, UL 1431, CSA C22.2 64 and 678

## DETAILS

The Milton intelligent bidet seat offers fully customizable rear and front cleansing options. Additional oscillating, pulsating massage and aerated bubbly water infusion technology are just a few of the customizable features you can personalize and program into your Milton intelligent bidet. Unlike clunky bidet models that require tank water heating systems, the Milton intelligent bidet seat features instant water heating technology to reduce your water demands while ensuring a luxurious and comfortably warm bidet cleansing experience. This instant heating technology also lends its space-saving benefits to the Milton's slim, modern design.

**TELESCOPING ELONGATED BIDET SEAT FB106**

**LIST PRICE: \$175.00 USD**

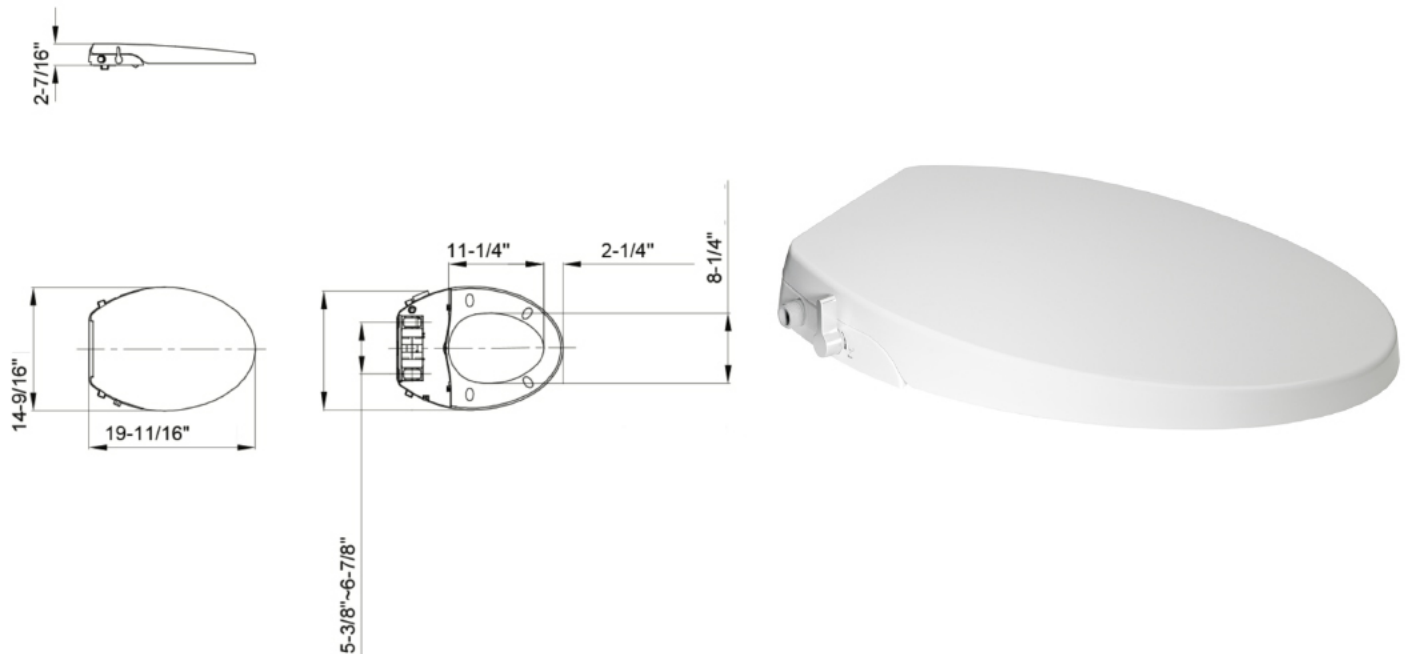

**FEATURES**

Dimensions	L 18-11/16" x W 14-9/16" x H 2-7/16"
Weight	6.4 lbs
Material Finish	Polypropylene
Color	White

**DETAILS**

This powerless bidet seat features rear wash, front wash, slow closing and an antibacterial nozzle – and it functions completely without electricity. Controlled by a discrete side knob, you can conveniently adjust the water flow to your preference(s). And for extra convenient cleaning, the seat and lid are easily removed within seconds.



**TRADITIONAL ELONGATED BIDET SEAT FB107**

**LIST PRICE \$175.00 USD**

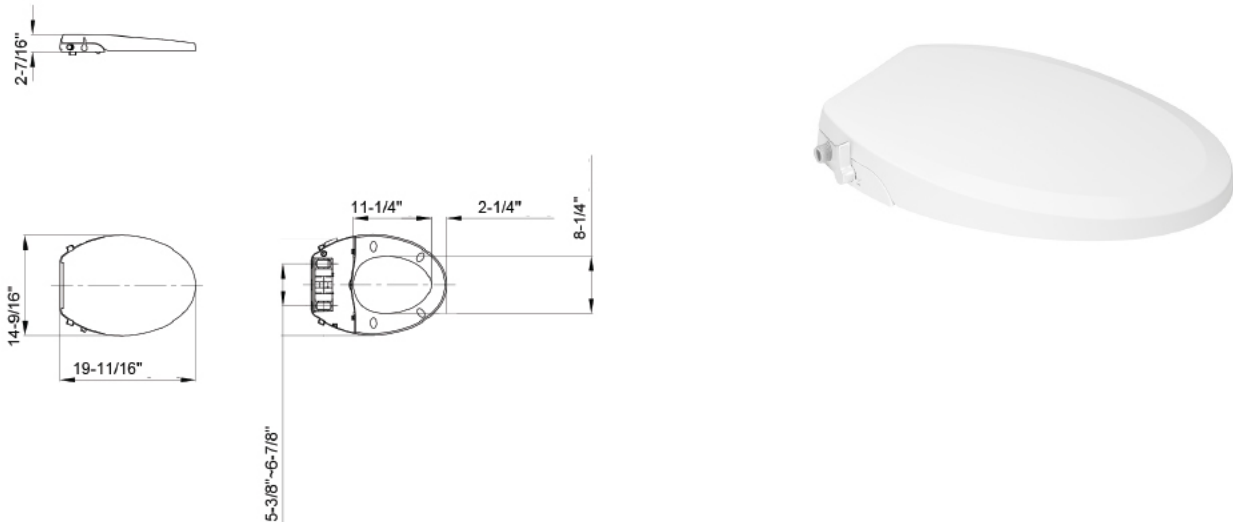

**FEATURES**

Dimensions	L 17-14/16" x W 14-9/16" x H 2-7/16"
Weight	6.4 lbs
Material Finish	Polypropylene
Color	White

**DETAILS**

This powerless bidet seat features rear wash, front wash, slow closing and an antibacterial nozzle – and it functions completely without electricity. Controlled by a discrete side knob, you can conveniently adjust the water flow to your preference(s). And for extra convenient cleaning, the seat and lid are easily removed within seconds.

**ROUND FRONT BIDET SEAT FB108**

**LIST PRICE \$175.00 USD**

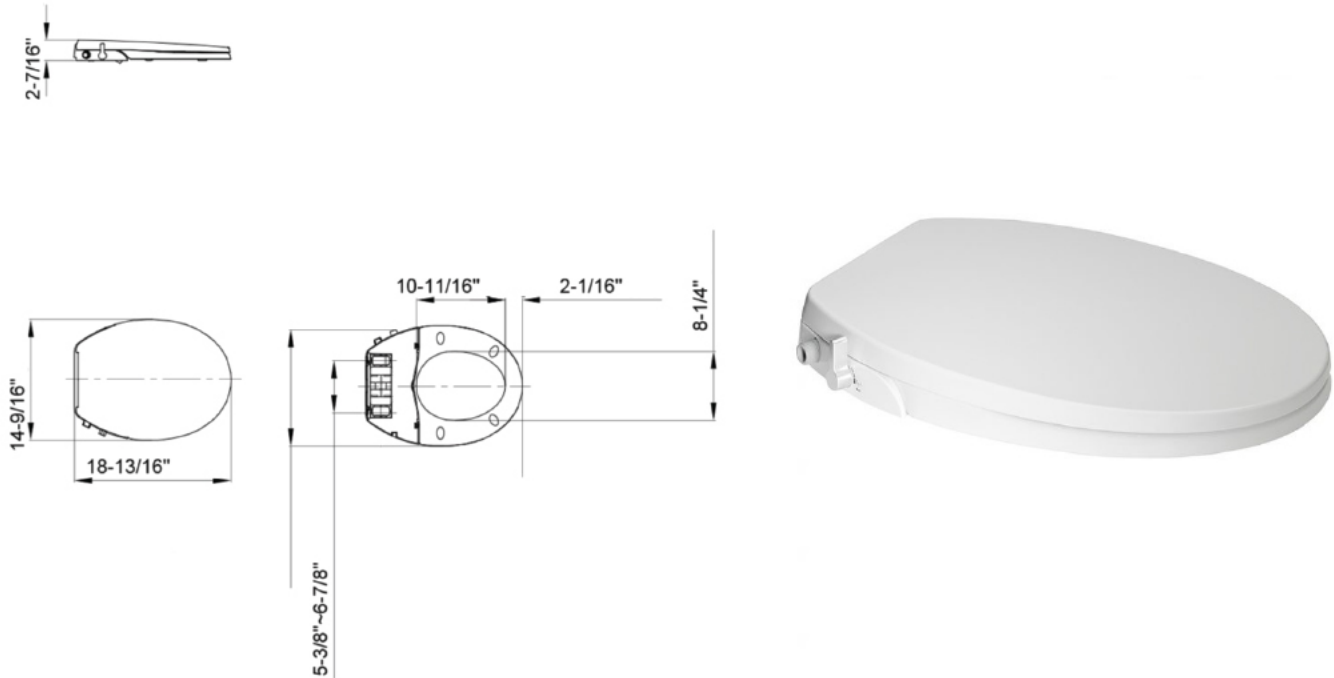

**FEATURES**

Dimensions	L 17-14/16" x W 14-9/16" x H 2-7/16"
Weight	6.2 lbs
Material Finish	Polypropylene
Color	White

**DETAILS**

This powerless bidet seat features rear wash, front wash, slow closing and an antibacterial nozzle – and it functions completely without electricity. Controlled by a discrete side knob, you can conveniently adjust the water flow to your preference(s). And for extra convenient cleaning, the seat and lid are easily removed within seconds.

# LITE

INTELLIGENT E-BIDET SEAT (U-SHAPED) FE105

LIST PRICE: \$ 450.00 USD

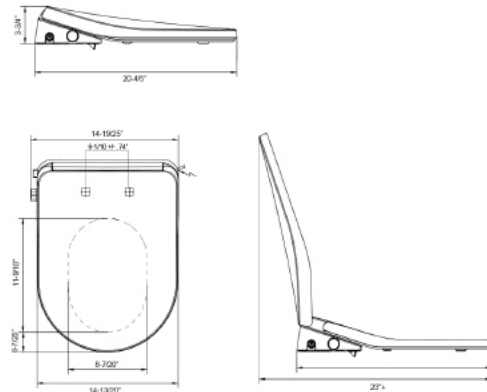

## FEATURES

Dimensions	L 20-1/5 x W 14-4/5" x H 3-3/4"
Weight	7.75 lbs
Material Finish	Polypropylene
Color	White
Configuration	Elongated, U-Shaped Intelligent Bidet Seat
Power	960W
Voltage	120V, 60Hz
Water Pressure	20-100 psi

## DETAILS

The LITE intelligent E-bidet seat offers instant seat and water warming, a luxurious and adjustable cleansing shower spray, and a soft-closing seat all in a low-profile and minimalistic style. The LITE intelligent E-bidet seat's gentle showering function can be customized with the turn of a conveniently located dial.

# LITE

INTELLIGENT E-BIDET SEAT (V-SHAPED) FE106

LIST PRICE: \$ 450.00 USD

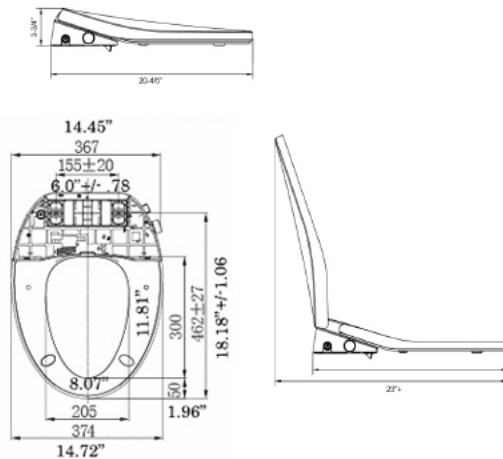

## FEATURES

Dimensions	L 20-1/5 x W 14-4/5" x H 3-3/4"
Weight	7.75 lbs
Material Finish	Polypropylene
Color	White
Configuration	Elongated, V-Shaped Intelligent Bidet Seat
Power	960W
Voltage	120V, 60Hz
Water Pressure	20-100 psi

## DETAILS

The LITE intelligent bidet seat offers instant seat and water warming, a luxurious and adjustable cleansing shower spray, and a soft-closing seat all in a low-profile and minimalistic style. The LITE intelligent E-bidet seat's gentle showering function can be customized with the turn of a conveniently located dial.

# TERMS & CONDITIONS

---

This order form is not an offer to sell to any person who possesses, nor to anyone else, the products listed herein at the prices shown. All prices are in U.S. dollars. These prices do not include freight, shipping and or handling.

## TERMS AND CONDITIONS OF SALE

Buyer's acceptance of all or partial goods ordered from seller shall constitute buyer's acceptance of AXENT Corporation's terms and conditions of sale set forth on order confirmation or invoice unless buyer objects in writing prior to acceptance of said goods.

## CREDIT APPROVAL

Acceptance of orders, shipments, deliveries and performance of work shall at all times be subject to approval of the Seller's Credit Department, AXENT Corporation, Irvine, California. Seller may at any time decline an order or decline to make any shipment or delivery or perform any work except upon receipt of payment, or security, or upon terms and conditions satisfactory to such department. Seller reserves the right to ship C.O.D. or C.I.A.

## TERMS OF PAYMENT

Cash payment terms are Net 30 Days. A delinquency charge, 1.5% per month or 18% per year, computed on the unpaid balance shall be due as liquidated damages on all accounts not paid in full when due. Interest shall be paid with Buyer's next remittance. In addition to late payment charges, Buyer agrees to pay any and all collection costs, including reasonable attorney fees incurred by Seller in collecting balances not paid within terms.

## FREIGHT

All orders are FOB California Warehouse. Seller reserves the right to ship merchandise by the method of seller's choosing.

## SHIPPING WEIGHTS

Shipping weights are approximate and are not guaranteed, but are shown for customer convenience.

## RETURNED MERCHANDISE

Merchandise which has been shipped according to Buyer's specifications cannot be returned for credit without prior written approval from the seller, fully establishing the basis for the credit. Credit will be issued only for items which are found by seller to be of standard manufacture and in saleable condition. Return shipment is at buyer's expense and risk. Buyer must prepay freight and will incur up to a 45% restocking charge when no manufacturing defects or errors are involved. Discontinued merchandise will not be accepted under this return goods program. No merchandise will be accepted for return under this policy after 30 days.

## DAMAGE IN TRANSIT/SHORTAGE

Every reasonable precaution is taken against breakage or damage in transit. Seller's risk of loss ceases at the time the goods are placed at the Buyer's disposal. Claims against carriers are to be filed by the Buyer within 7 days. It is the buyer's responsibility to inspect products upon delivery for transit and/or shortage. If damage or shortage is detected, it should be duly noted on the bill of lading before signing for merchandise. An inspection report should be requested by the buyer of the carrier, followed by a settlement claim to the carrier.

## WARRANTY

See AXENT product warranty for details. If you do not have a copy of the product warranty, please request in writing to:  
AXENT Corporation  
3 Musick  
Irvine, CA 92618

## DESIGN CHANGES

Seller reserves the right to make revisions without notice in the design of its products and packaging.

## DELAY

If any shipping dates have been specified, they are approximate and seller shall not be bound thereby, but every effort will be made to ship in accordance with them. All shipments are subject to contingencies of manufacturer and other causes beyond



# VITREOUS CHINA & FINE FIRE CLAY WARRANTY

## AXENT Limited Warranty

Limited Warranty applies to all AXENT products.

AXENT warrants its products to be free of manufacturing defects in material and workmanship for a period of 5 years on Vitreous China and 3 year on tank trim / seats and from the date of purchase. Please visit <http://eeurl.com/gdt5fX> to register within 30days after purchase. The limited warranty is to the original purchaser only. The limited warranty is not transferable to any third party. The limited warranty applies to all products sold in the United States and Canada. AXENT is not responsible for any installation costs.

AXENT will at its election replace or make appropriate adjustments where AXENT inspection discloses any such defects occurring in normal residential usage within one year after purchase.

This warranty does not apply to the following items

- Damage or loss sustained in a fire, earthquake, storm or any natural disaster etc....
- Damage or loss resulting from any unreasonable use, misuse, abuse, negligence or improper care, improper cleaning or maintaining of the product.
- Damage or loss resulting from any sediments or foreign matter contained in the water system
- Damage or loss from improper installation, harsh environment, improper removal and water pressure in excess of 80PSI.
- Damage or loss resulting from electrical surges, lightning strikes or other acts which are not considered normal or the fault of AXENT.
- Damage or loss resulting from normal wear and tear, such as gloss reduction or dulling, scratching or fading over time due to normal use, cleaning practices, water or atmospheric conditions including but not limited to: bleach, alkali, acid cleaners, dry powdered cleaners or any other abrasive cleaning agents or abrasive cleaning tools or aids.
- The use of any product in a manner outside of the product instructions / owner's manuals
- AXENT shall not be liable for any failure caused by Chloramines in the public treated waters or cleaners containing chlorine (calcium hypochlorite). Please Note that use of high concentrate chlorine or chlorine related products can damage fittings. This damage can cause leakage resulting in property damage.

This limited warranty gives you specific legal rights. You may have other rights which may vary from state to state, province to province or country to country

To obtain warranty service you may contact AXENT through your dealer, plumbing contractor or by writing AXENT, Attn. customer service department, 3 Musick, Irvine, California 92618 or by calling 1-800-769-4857.

**IMPLIED WARRANTIES, INCLUDING THAT OF MERCHANTABILITY, ARE EXPRESSLY LIMITED IN DURATION TO THE DURATION OF THIS WARRANTY. AXENT DISCLAIMS ANY RESPONSIBILITY FOR CONSEQUENTIAL DAMAGES.**

Some states do not allow limitations on how long an implied warranty lasts or the exclusion or limitation of special, incidental or consequential damages, so this limitation and exclusion may not apply to you. This warranty gives you specific legal rights. You may also have other rights which vary from state to state.

## **Vitreous China and Fine Fire Clay – Care**

Clean the outside surface of your toilet or lavatory with mild soap and warm water. Wipe the entire surface completely dry with a clean soft cloth. You may use soft abrasive cleaners when necessary to clean your vitreous china and fine fire clay product. Do not use strong abrasive cleaners, as they will scratch and dull the surface. Wipe any splashes of cleaning solutions from plastic or plated surfaces immediately. Use toilet bowl cleaners on the inside of the toilet bowl only.

If the surface becomes excessively dirty, use a general purpose cleaner such as Fantastick®, All Purpose Lysol®, Basin Tub and Tile Cleaner®, Soft Scrub® Multi Surface, Scrub Free® Disinfectant Bathroom Cleaner, Clorox Clean-Up®, Spic and Span Liquid, Comet® Liquid Bathroom Cleaner, Scrubbing Bubbles® Bathroom Cleaner, BarKeeper's Friend®, or Bon Ami.

Over time, hard water deposits may clog the toilet rim washing holes and trap ways. To clean, use a commercial cleaner that is recommended for removing hard water deposits. Be sure to follow the cleaner's manufacturer's instructions.

**WARNING** Risk of property or product damage. Do not use in-tank cleaners in your toilet. Products containing chlorine (calcium hypochlorite) can seriously damage tank fittings. The damage can cause leakage and severe property damage.

# Notes

---

AXENT Switzerland  
USA Office  
3 Musick, Irvine, CA 92618  
1-800-769-4857  
support@AXENTproducts.com  
www.AXENTbath.us

